

- PUBLIC WORKS - 1,959 SQ. FT.
- CONSTRUCTION MANAGEMENT - 1,457 SQ. FT.
- NATURAL RESOURCES - 1,242 SQ. FT.
- SHARED TRAINING ROOM - 1,332 SQ. FT.
- CIRCULATION - 743 SQ. FT.
- RESTROOMS - 446 SQ. FT.

7,500 SQ. FT.  
**FLOOR PLAN AREA 'A'**

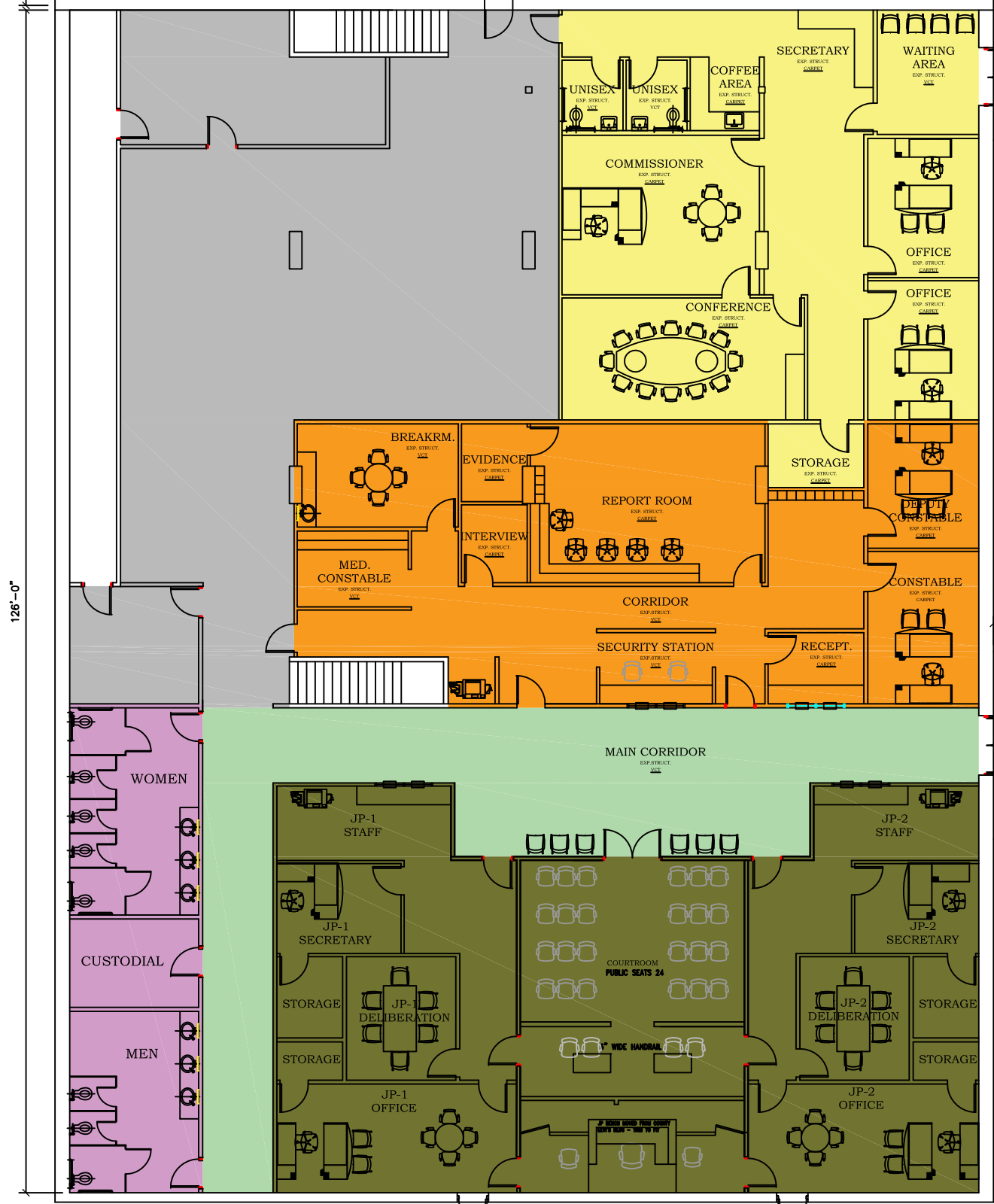

- VACANT SPACE - 2,583 SQ. FT.
- COMMISSIONER - 2,027 SQ. FT.
- CONSTABLES AREA - 2,774 SQ. FT.
- JP'S AREA - 2,987 SQ. FT.
- CIRCULATION - 1,286 SQ. FT.
- RESTROOMS - 737SQ. FT.

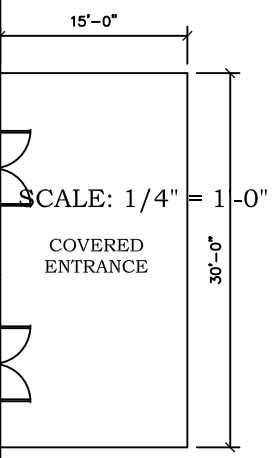
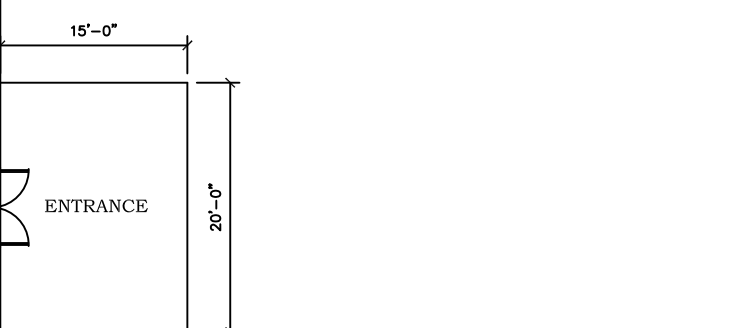

12,600 SQ. FT.  
**FLOOR PLAN AREA 'B'**